

S7B



TABELLA DI PERFORMANCE PERFORMANCES TABLE

		S7B 1400	2000	2500	3000	3600	4300
Displacement / Cilindrata	[cc/rev]	1373	2007	2471	2985	3611	4298
Bore / Alesaggio	[mm]	82	82	110	100	110	120
Stroke / Corsa	[mm]	52	76	52	76	76	76
Specific Torque / Coppia Specifica	[Nm/bar]	21,9	31,9	39,3	47,5	57,5	68,4
Pressure Rating / Press. Nominale	[bar]	250					
Peak Pressure / Pressione di Picco	[bar]	420					
Cont. Speed / Velocità continua	[rpm]	425	425	425	400	375	300
Max. Speed / Velocità max.	[rpm]	650	650	650	600	550	450
Peak Power / Potenza di Picco	[kW]	400					

Approximative weight	290	[kg]	Peso approssimativo	290	[kg]
Approximative oil capacity	21	[l]	Capacità di olio approssimativa	21	[l]
Max casing Pressure ² continuous	3	[bar]	Pressione max in carcassa ² continuo	3	[bar]
peak	6	[bar]	picco	6	[bar]
Note:			Note:		
1) Continuous or average working pressure should be chosen in function of the bearing lifetime. For lifetime calculation of motor bearings please consult SAI Tech. Dept.			1) La pressione continua o media di lavoro va determinata in funzione della vita dei cuscinetti. Per un calcolo di vita dei cuscinetti del motore consultare l'Ufficio Tecnico SAI.		
2) For higher case pressure please consult SAI Tech. Dept.			2) Per pressioni più elevate in carcassa consultare l'Ufficio Tecnico SAI		

520

160 37 303 20

620

Ø 300 f7

N°10 HOLES M 20

40 50

15

S7B

80x3x25
DIN 5480

Ø 110

Ø 361 -0.05
+0.03

Ø 419

Ø 490

10

30

N°5 HOLES Ø 22

420

44.5 145

N°8 HOLES M20

N°

96.8

FLANG 2" 6000 PSI

N° FORI 1/2 BSP

2 3 4

R 210

145

ALBERI

* Non disponibile con S7-1400/2500

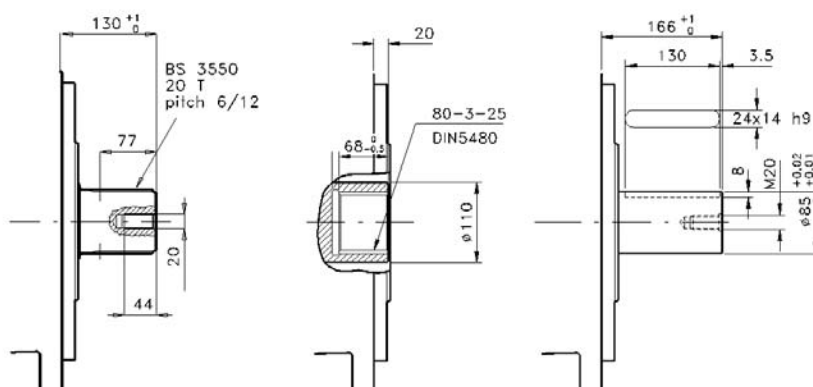
ADAPTORS
MANICOTTI

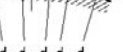
DIN 	80-3-25 DIN 5480		pitch 6/12 BS3550	
	d0	Ø75.0	A	Ø88.0 ^{-0.047} _{-0.17}
	d1	Ø80.0 ^{+0.070} ₊₀ H14	B	Ø84.6
	d2	Ø74.0 ^{+0.190} ₊₀ H11	C	Ø80.0 ^{-0.430} _{-0.070}
	A	Ø5.25	D	Ø97.0 ^{+0.062} _{+0.030}
			E	Ø8.12
BS3550 	da	Ø68.9 H9		
	d3	Ø79.4 ⁻⁰ _{-0.190} h11		
	d4	Ø73.4 ⁻⁰ _{-0.070} h14		
	B	Ø6.0		
	db	Ø85.9 f8		

